

108

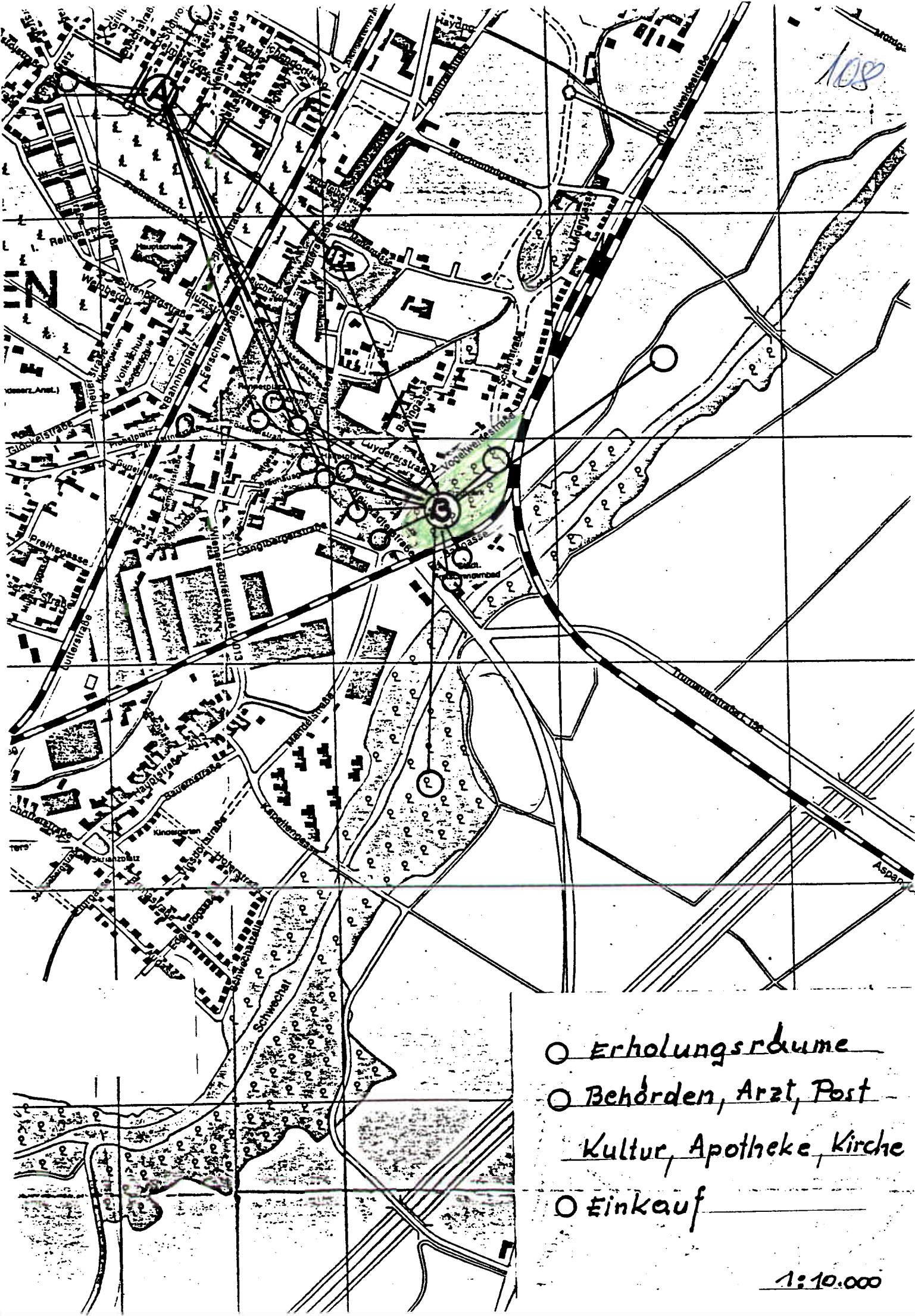

- Erholungsraum
- Behörden, Arzt, Post
- Kultur, Apotheke, Kirche
- Einkauf

1:10.000

# DIE BEABSICHTIGTE WIDMUNGS- ÄNDERUNG IM STADTPARK

108

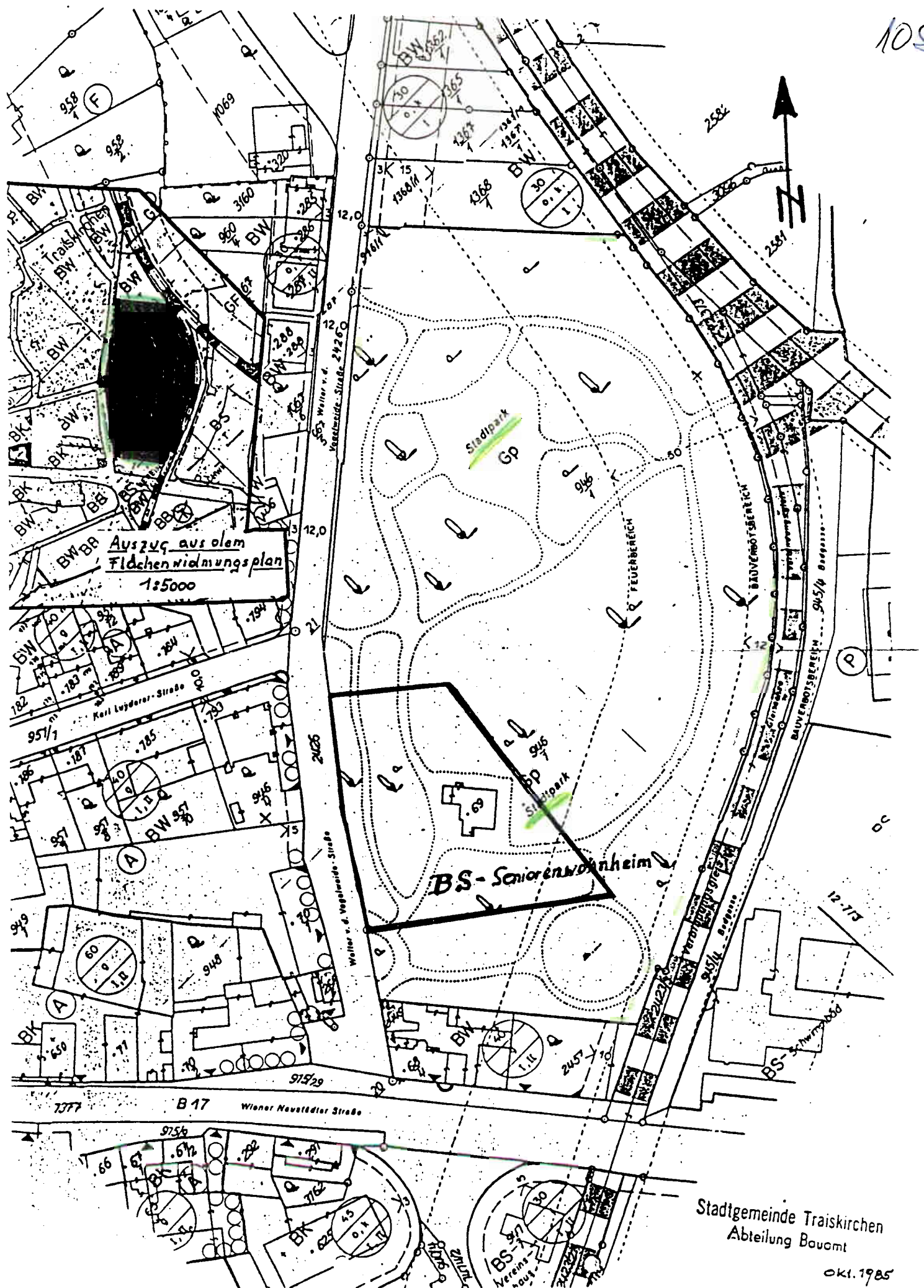





Auszug aus dem  
Flächenwidmungsplan  
1:5000

BS-Seniorenwohneheim

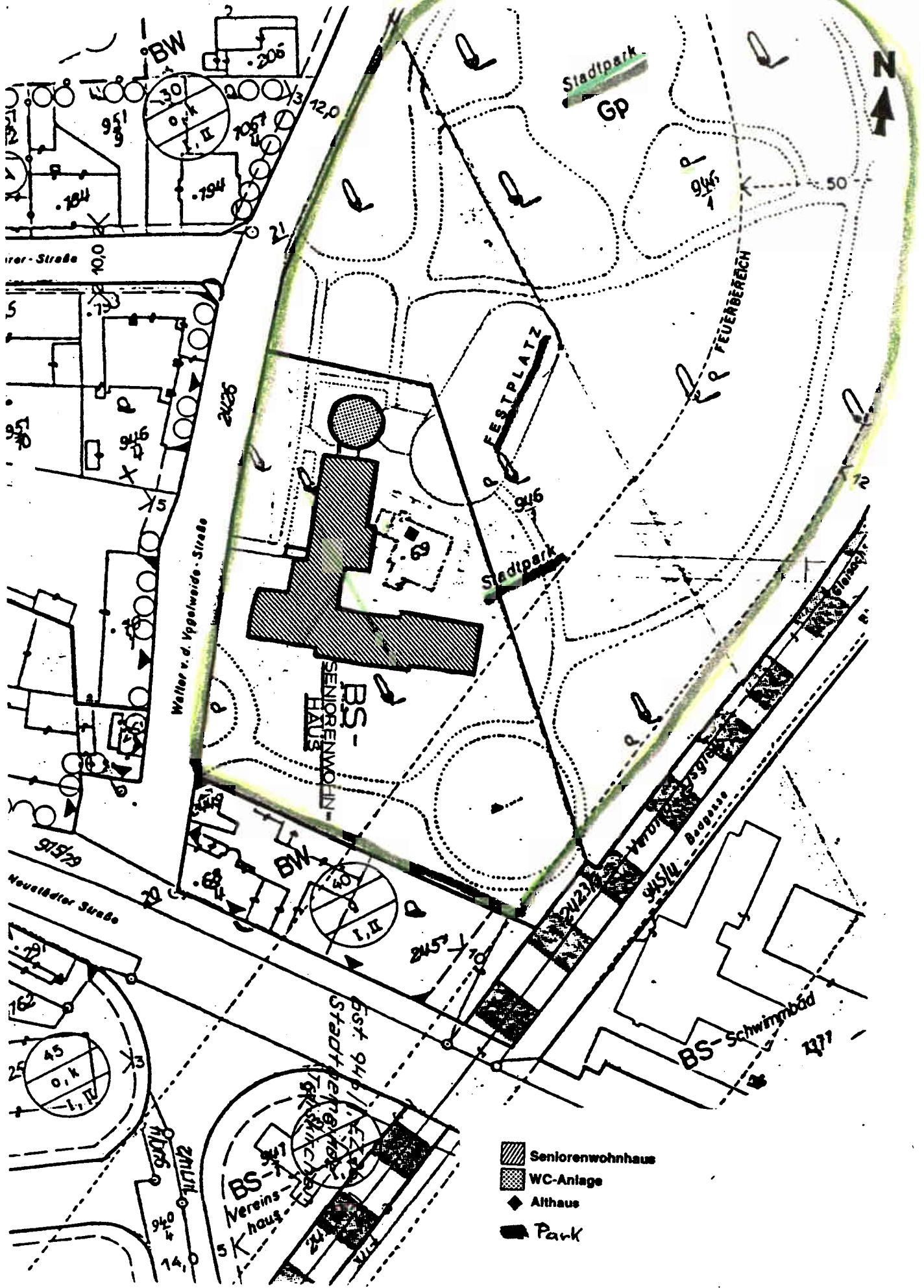
Stadtgemeinde Traiskirchen  
Abteilung Bauamt

OKI. 1985



-  Seniorenwohnhaus
-  WC-Anlage
-  Althaus
-  Park